

# HITCHING & TOWING ACCESSORIES

Combination Ball/Pintle Hitch & Receiver Mounted Pintles

Rigid Mount Pintle Hooks

Swivel Mount & Spring Mounted Pintle Hooks

Swivel Mount Tow Rings

Rigid Mount Tow Rings

Trailer Nose Plates

King Pins

Fold-Down Ball & Mounting Rail Kits (Buyers)

Bolt-On Ball Frame Mounting Rail Kits (Buyers)

Gooseneck Plates

Remov-A-Ball® & Fold Down Above Bed Goosenecks

Bolt-On Frame Mounting Rail Kits & Under Bed Goosenecks

Turnover Ball & Turnover Ball Accessories

Fifth Wheels & Rail Kits

Blue Ox® Tow Bars & Accessories

Trailer Ball

Trailer Ball Cover

Reducer Bushing

Trailer Hitch Grease

Chrome Balls and Shanks

Stainless Steel Balls and Shanks

Balls and Shanks Storage

Ball Mounts w/2 & 3 Welded Trailer Balls

Tow Hooks

Tow & Stow™ Receiver Hitches

Tow & Stow™ Pintle Hitches & Accessories

Aluminum Rapid Hitches

Rapid Hitch Replacement Parts

Locks For Rapid Hitch

8K Aluminum Ball Mounts

Ball Mounts & Dual Receiver Adapter

Cushion Ball Mounts

Pintle Mounts

Solid Shanks

Step Bumper Hitches

Hitch Adapters & Receiver Extensions

Receiver Tubes & Tube Covers

Bent Pins w/Hairpin Clip

Cargo Carries

Weight Distribution Kits

Sway Control

Hitch Application

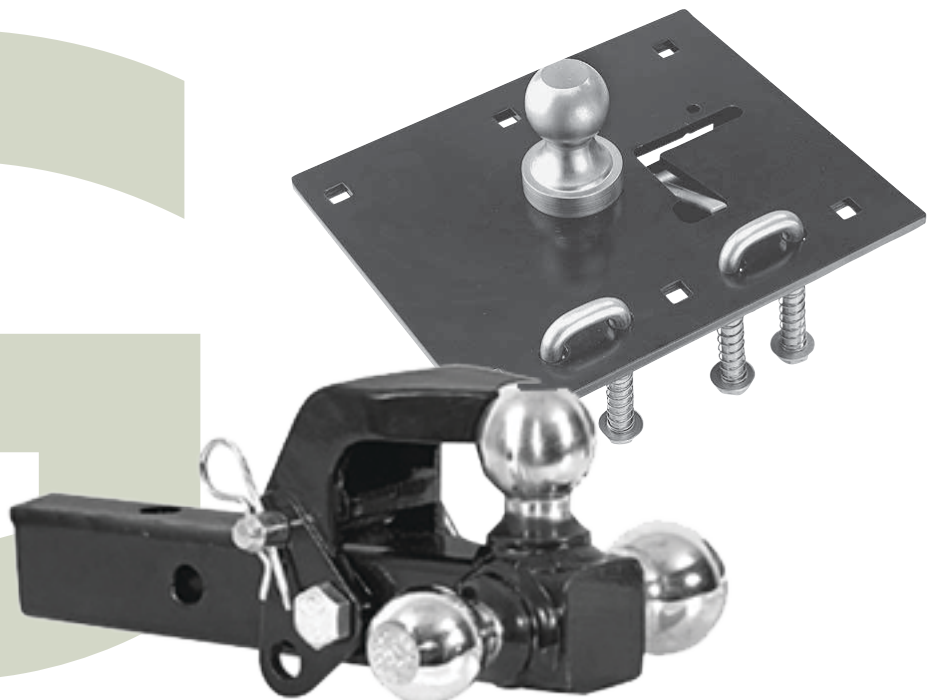

Information

Hubs  
& AxlesBrake  
AssembliesSuspensions  
& FastenersTires &  
WheelsCouplers  
Jacks &  
WinchesHitches &  
Towing  
AccessoriesBody  
Components

Trailer Parts

Lights &  
ElectricalLocks &  
Cargo ControlBrake  
Actuating  
Systems

Switches



## Receiver Hitch Types







### Custom Fit 1 Piece

Custom fit hitches are the easiest to install. These application specific hitches are available in Class II, Class III, Class IV, and Heavy Duty.

### Multi-Fit 3 Piece

Designed to fit a wider range of vehicles than Custom Fit hitches, the Multi-Fit units require some assembly. Popular for retail and when stocking a limited line of hitches, the Multi-Fit units are available in Class II, Class III, and Class IV.

### Choose the right hitch to handle the load

Trailer Types:						
Hitch Class:	Class I	Class II	Class III	Class IV	5th Wheel	Gooseneck
Maximum Load Capacity:	Gross Trailer Weight Up to 2,000 lbs. Tongue Weight Up to 200 lbs.	Gross Trailer Weight Up to 3,500 lbs. Tongue Weight Up to 350 lbs.	Gross Trailer Weight Up to 5,000 lbs. Tongue Weight Up to 500 lbs.	Gross Trailer Weight Up to 12,000 lbs. Tongue Weight Up to 1,200 lbs.	Gross Trailer Weight Up to 24,000 lbs.	Gross Trailer Weight Up to 25,000 lbs. Tongue Weight Up to 6,250 lbs.
Tow Vehicle						
Sub Compact & Compact Cars	X	Not Recommended	Not Recommended	Not Recommended	Not Applicable	Not Applicable
Mid Size Cars	X	X	Not Recommended	Not Recommended	Not Applicable	Not Applicable
Mid Size Pickups & Sport Utility Vehicles & Minivans	X	X	X	Not Recommended	X Pickups Only	X Pickups Only
Full Size Cars Pickups & Sport Utility Vehicles & Minivans	X	X	X	X	X Pickups Only	X Pickups Only

**Gross Trailer Weight** is the total weight of the trailer as it is towed.  
This includes the weight of the trailer and all of its contents.

**Tongue Weight** is the load supported by the hitch when the trailer is connected to the trailer ball.  
Excess tongue weight will cause unstable towing as weight is shifted  
from the vehicle's front suspension to the rear suspension.

## Combination Ball/Pintle Hitch

& Receiver Mounted Pintles

(See page G18 & G19 for pintle mounts for receiver hitches)

Part #	Ball Size & Capacity	Trailer GVW Pintle	Max Vertical	Mounting Bolt Size & Spacing Dia. - W x H	Grade 8 Mounting Kit Part #	Replacement Ball (Shank Size)		
						1"	1 1/8"	1 1/4"
6031	1 7/8" 2,000 lbs	16,000	16,000	1/2" - 3 3/8" x 1 3/4"	2533	2533	2533	2533
6032	2" 7,000 lbs	16,000	16,000	1/2" - 3 3/8" x 1 3/4"	2533	2533	2533	2533
6033	2 5/16" 12,000 lbs	16,000	16,000	1/2" - 3 3/8" x 1 3/4"	2533	2533	2533	2533



**6031**

Part #	Ball Size & Capacity 1 1/8" Shank	Trailer GVW Pintle	Max Vertical	Mounting Bolt Size & Spacing Dia. - W x H	Mounting Pin Part #	Replacement Ball (Shank Size)		
						1"	1 1/8"	1 1/4"
6034	2" 7,000 lbs	12,000	2,400	2" Tube 5/8" Pin	2560	2302	2308	-
6035	2 5/16" 12,000 lbs	12,000	2,400	2" Tube 5/8" Pin	2560	2303	2309	-



**6034**

Part #	Description
2486	Tri-Ball mount with Pintle Hook; Pintle rating 7,500 lbs; 25/16" rating 10,000 lbs; 2" rating 7,500 lbs; 17/8" rating 6,000 lbs; 2" Solid Shank.



**2486**

Part #	Ball Size & Capacity 1 1/8" Shank	Trailer GVW Pintle	Max Vertical	Mounting Bolt Size & Spacing Dia. - W x H	Mounting Pin Part #	Replacement Ball (Shank Size)		
						1"	1 1/8"	1 1/4"
6055	-	10,000	2,400	2" Tube 5/8" Pin	2560	-	-	-



**6055**

## Rigid Mount Pintle Hooks

(See page G18 & G19 for pintle mounts for receiver hitches)

Part #	Trailer GVW Pintle	Max Vertical	Mounting Bolt Size & Spacing Dia. - W x H	Replacement Latch Part #	Grade 8 Mounting Kit Part #
6050	5 Ton (10,000 lbs)	2,000 lbs	1/2" - 3 3/8" x 1 3/4"	-	2533
6051	8 Ton (16,000 lbs)	3,200 lbs	1/2" - 3 3/8" x 1 3/4"	-	2533
6052	15 Ton (30,000 lbs)	6,000 lbs	1/2" - 3 3/8" x 1 3/4"	-	2533
6053	20 Ton (40,000 lbs)	6,000 lbs	5/8" - 3 3/8" x 1 3/4"	-	2532
6054	30 Ton (60,000 lbs)	14,000 lbs	1/2" - 3 3/8" x 1 3/4"	-	2533



**6050**



**6082**



**6056**

Part #	Trailer GVW Pintle	Max Vertical	Mounting Bolt Size & Spacing Dia. - W x H	Replacement Latch Part #	Grade 8 Mounting Kit Part #
6056	30 Ton (60,000 lbs)	15,000 lbs	3/4" - 4 1/2" x 4 1/2"	6082	-
6057	45 Ton (90,000 lbs)	16,000 lbs	3/4" Dia; 5 1/4" Top Ctrs; 6 1/2" Bottom Ctrs; 3" High	-	-



**6057**

Information

Hubs & Axles

Brake Assemblies

Suspensions & Fasteners

Tires & Wheels

Couplers, Jacks & Winches

Hitches & Towing Accessories

Body Components

Trailer Parts

Lights & Electrical

Locks & Cargo Control

Brake Actuating Systems

Switches

## Swivel Mount & Spring Mounted Pintle Hooks

**6061**

Part #	Trailer GVW Pintle	Max Vertical	Mounting Bolt Size & Spacing Dia. - W x H	Replacement Latch Part #
6061	8 Ton (16,000 lbs)	2,000 lbs	½" - 3⅝" x 1¾"	-

**6062**

Part #	Trailer GVW Pintle	Max Vertical	Mounting Bolt Size & Spacing Dia. - W x H	Replacement Latch Part #
6062	15 Ton (30,000 lbs)	3,200 lbs	½" - 3⅝" x 1¾"	6082

**6082**

**6064**

Part #	Trailer GVW Pintle	Max Vertical	Mounting Bolt Size & Spacing Dia. - W x H	Replacement Latch Part #
6064	25 Ton (50,000 lbs)	6,000 lbs	½" - 3⅝" x 1¾"	-

**6063**

Part #	Trailer GVW Pintle	Max Vertical	Mounting Bolt Size & Spacing Dia. - W x H	Replacement Latch Part #
6063	50 Ton (100,000 lbs)	9,800 lbs	¾" - 6½"	6084

**6065**

Part #	Trailer GVW Pintle	Max Vertical	Mounting Bolt Size & Spacing Dia. - W x H	Replacement Latch Part #
6065	30 Ton (60,000 lbs)	20,000 lbs	⅞" - 4½" x 4½"	6084

## Swivel Mount Tow Rings

**6070**

Part #	Inside Diameter x Section Diameter	Trailer GVW	Max Vertical	Shank Diameter x Length
6070	2½" x 1½"	15,000 lbs	3,000 lbs	1½" x 3¼"
6072	3" x 1⅝"	45,000 lbs	9,000 lbs	2" x 4¼"

**6073**

Part #	Inside Diameter x Section Diameter	Trailer GVW	Max Vertical	Shank Diameter x Length
6073	3" x 1⅝"	45,000 lbs	9,000 lbs	2" x 8½"

## Swivel Mount Tow Rings

Part #	Inside Diameter x Section Diameter	Trailer GVW	Max Vertical	Mounting Bolt Size & Spacing Diameter W x H	Attachment Method
6071	2½" x 1"	10,000 lbs	1,000 lbs	Tab = ⅝" x 2½" W x 2" L	Weld-on

Part #	Inside Diameter x Section Diameter	Trailer GVW	Max Vertical	Mounting Bolt Size & Spacing Diameter W x H	Attachment Method
6077	2½" x 1⅝"	42,000 lbs	6,000 lbs	⅝" - 4½" x 4½"	Bolt-on

Part #	Inside Diameter x Section Diameter	Trailer GVW	Max Vertical	Mounting Bolt Size & Spacing Diameter W x H	Attachment Method
6078	3" x 1⅝"	60,000 lbs	15,000 lbs	¾" - 4½" x 4½"	Bolt-on

Part #	Inside Diameter x Section Diameter	Trailer GVW	Max Vertical	Mounting Bolt Size & Spacing Diameter W x H	Attachment Method
6074	3" x 1⅝"	22,000 lbs	4,500 lbs	⅝" - 2" Centers	Bolt-on

Part #	Inside Diameter x Section Diameter	Trailer GVW	Shank D x L	Hole Dia.	Hole Center to Shank Center	Attachment Method
* 6079	3" x 1⅝"	30,000 lbs	1¾" x 3½"	1⅝"	3½"	Bolt-on
* 6081	3" x 1⅝"	50,000 lbs	2" x 3½"	1⅝"	4½"	Bolt-on

**NOTE:** \* Includes 2 nuts, 2 washers, 1 bolt & 1 mounting plate.

Part #	Inside Diameter x Section Diameter	Trailer GVW	Max Vertical	Mounting Bolt Size & Spacing Diameter W x H	Attachment Method
18128	3" x 1⅝"	14,000 lbs	2,000 lbs	⅝" - 2" Vertical Centers	Hardware &
18127	3" x 1⅝"	20,000 lbs	2,000 lbs	⅝" - 2" Vertical Centers	Adj. Channel
18126	2½" x 1"	20,000 lbs	1,000 lbs	⅝" - 2" Vertical Centers	(see page F6)
18128-K	#18128 Adjustable Lunette Eye, #18978 Channel & Bolt Kit				
18128-XL	#18128 Adjustable Lunette Eye, #18977 Channel & Bolt Kit				

## Trailer Nose Plates

Accepts standard 4½" square bolt pattern. Allows for 3 mounting positions.  
Requires Grade 8 bolts and nuts (not included).

Part #	Fits # Drawbar	Thickness	Hole Diameter	Use Bolt Size	Weight
TNP716625750	6077	¾"	21/32"	⅝"	24 lbs
TNP716750100	6078	1"	25/32"	¾"	32 lbs

## King Pins

Part #	Fits # Drawbar
6005	2" King Pin for ¼" bolster plate thickness Forged from AISI 8630 steel and heat-treated to create and maintain a hardness of 302-363 BHN. The combination of material and process will maintain approximately 150,000 psi in ultimate strength which will meet or exceed the performance specifications set by SAE.
6010	2" Retractable King Pin 32,000 GVWR Requires 9" square hole cut in truck bed, and ¼" thick support plate (not included)



6071



6077



6078



6074



6079



18128



TNP716625750



6005



6010

Information

Hubs  
& Axles

Brake  
Assemblies

Suspensions  
& Fasteners

Tires &  
Wheels

Couplers  
Jacks &  
Winches

Hitches &  
Towing  
Accessories

Body  
Components

Trailer Parts

Lights &  
Electrical

Cargo Control

Locks &  
Cargo Control

Brake  
Actuating  
Systems

Switches



## Buyers Gooseneck Flip Ball Hitch

- Under bed flip ball hitch design, allows for an unobstructed bed when not towing a trailer
- 2-5/16" Machined ball is zinc coated for added corrosion resistance
- Built in safety chain hook-ups
- Requires only 4" hole in bed
- MGTW 30,000 lb, MVL 7,500 lb
- Bolts to truck frame utilizing existing factory holes, with no drilling or welding
- Wheel well accessible quick release lock, no climbing into truck bed
- Simple installtion, bed removal not required



7030C

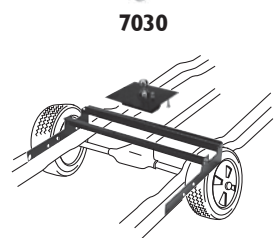

7030



7034



51066



6002DT



6005DT

## Fold-Down Ball & Mounting Rail Kits (Buyers)

Part #	Trailer GVW	Description / Application
7030	25,000 lbs	A locking collar secures the 2 5/16" ball when in the up position. Safety chain U-bolts are included to comply with D.O.T. regulations. Some Dodge applications will require longer safety chain U-bolt Kit #43251.
43250		Standard Safety Chain U-Bolt Kit (Included with #7030)



## Bolt-on Ball Frame Mounting Rail Kits (Buyers)

(Rail kits are rated to match vehicle weight ratings - 15,000 lbs max.)

Part #	Year/Model	Mfg #	Description / Application
7034	1988-1998 <b>Chevy/GMC</b>	09001010	1/2-ton 1500, 3/4-ton, 2500, 1-ton 3500 old body style with short bed and all cab types except crew cab.
7032	2005-2011 <b>F250/F350 Super Duty</b>	09001023	3/4-ton F250, 1-ton F350 super-duty, all bed length & cab types including dually, Triton V10, and Power Stroke diesel models.

## Gooseneck Plates

Part #	Year/Model	Description / Application
51066	25,000 lbs	Gooseneck Hitch Plate with 2 5/16" Ball 5/16" Thick Steel Plate 13 1/2" x 42"

Part #	Year/Model	Description / Application
6002DT	25,000 lbs	Draw-Tite Gooseneck Plate with 2 5/16" Ball, (Same As Reese #58079 "The Goose"™) mounts to Industry Standard 5th Wheel Rail Kits, including Draw-Tite #6005, Reese #30035, Qualitys #FW14-4, and Others. Rail Kit Not Included.

Part #	Year/Model	Description / Application
6005DT	-	Rail & Installation Kit for #6002DT Goosenecks, Draw-Tite, Reese, Hidden Hitch, and other Fifth Wheels for Full Size Trucks.



## Remov-A-Ball® & Fold Down Above Bed Goosenecks

(Use Bolt-on rail kits shown below)

Part #	Trailer GVW	Description / Application
6300	30,000 lbs	Remov-A-Ball® Gooseneck Hitch Plate with 25/16" Ball
5973	30,000 lbs	Remov-A-Ball® 25/16" Replacement Ball
6303	30,000 lbs	Remov-A-Ball® 3" Replacement Ball
6467	-	Stainless Steel Cutting Template for Remov-A-Ball®
83399	25,000 lbs	Fold Down Hitch Plate with 25/16" Ball

## Bolt-on Frame Mounting Rail Kits

& Under Bed Goosenecks

Rail kits work with both "Above Bed" and "Under Bed" sections

Rail Part #	Head Part #	Year	Description / Application
4440	9475	88-00	Chevy/GMC Old Body Style, 1500/2500, 6' & 8' Bed - Except 88-91 4Dr Crew Cab
4454	9475	99-16	Chevy/GMC 1500 LD (Classic), 6.6' & 8' Bed, 2 & 4 WD
4454	9475	01-07	Chevy/GMC 1500 HD (Classic), 6.6' Bed, 2 & 4 WD
4454	9475	99-04	Chevy/GMC 2500 LD, (Classic), 6.6' Bed, 2 & 4 WD
4434	9475	99-04	Chevy/GMC 2500 LD, 8' Bed, 2 & 4 WD
4434	9475	01-07	Chevy/GMC 2500 HD (Classic), 6.6' & 8' Bed, 2 & 4 WD
4434	9475	07-10	Chevy/GMC 2500 HD, 6.6' & 8' Bed, 2 & 4 WD (New Body Style)
4434	9475	07-10	Chevy/GMC 3500 HD, 6.6' & 8' Bed, 2 & 4 WD (New Body Style)
4445	9475	01-07	Chevy/GMC 3500 Series (Classic), 8' Bed, 2 & 4 WD
4456	9475	11-16	Chevy/GMC 2500 HD, 6.6' & 8' Bed, 2 & 4 WD (New Body Style)
4456	9475	11-16	Chevy/GMC 3500 HD, 6.6' & 8' Bed, 2 & 4 WD (New Body Style)
4437	9475	04-14	Ford F-150, Regular & SuperCab 5.5', 6.5' & 8' Bed (New Body Style)
4437	9475	04-14	Ford F-150, SuperCrew 5.5' & 6.5' Bed (New Body Style)
4448	9470	99-15	Ford F-250/F-350, SD Pickups Only - Except cab & chassis
4449	9470	08-15	Ford F-450 SD Pickups Only - Except cab & chassis
4439	9470	94-01	Dodge 1500/2500/3500, 6' & 8' Bed
4439	9470	2002	Dodge 2500, 6' & 8' Bed
4439	9470	2002	Dodge 3500, 8' Bed
4438	9474	02-08	Dodge 1500 Only - Except Mega Cab
4435	9474	06-08	Dodge 1500 Mega Cab w/6' Bed, 2 & 4 WD
4435	9474	03-12	Dodge 2500 HD, Including Mega Cab, 2 & 4 WD
4435	9474	03-12	Dodge 3500 HD, Including Mega Cab & Dually, 2 & 4 WD
4446	9474	09-16	Dodge 1500 Regular Cab w/6.4' & 8' Bed - Except w/Air Suspension
4446	9474	09-16	Dodge 1500 Quad Cab w/6.4' Bed
4457	9474	10-12	Dodge 2500/3500 HD, Including Mega Cab, 2 & 4 WD
4457	9474	2013	Dodge 2500 HD, Including Mega Cab, 2 & 4 WD
-	9476	13-15	Dodge 3500 HD, Including Mega Cab & Dually, 2 & 4 WD
4436	9475	07-14	Toyota Tundra - Regular & Double Cab, 6.5' & 8' Bed & Crew Max 5.5' Bed

**NOTE:** Rail Kits are rated to match vehicle weight ratings. (15,000 lbs Max.)

See our separate Draw-Tite catalog for more specific applications, notes and installation times.



**6300**



**6467**

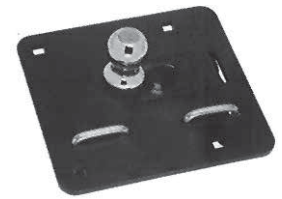

**83399**



**9461**



**6310**



## Bulldog Under-Bed Gooseneck Towing System



- Head tested to 30,000 lbs. GTW, 7,500 lbs. vertical load
- Only 3-1/2" hole in truck bed for installation
- Ball is stored upside-down in hitch when not used
- Heavy duty handle uses positive locking to engage ball
- Comes with gooseneck head, 2-5/16" ball and safety chain brackets • Easy to install
- Includes magnetic cover
- Rails are rated to meet non-commercial tow rating
- Rail kits average install time is less than 2-1/2 hours without any welding or bed removal

Information

Hubs & Axles

Brake Assemblies

Suspensions & Fasteners

Tires & Wheels

Couplers, Jacks & Winches

Hitches & Towing Accessories

Body Components

Trailer Parts

Lights & Electrical

Locks & Cargo Control

Brake Actuating Systems

Switches

## B & W Gooseneck Hitches

The B & W Turnover Ball™ System converts from a towing unit to a level bed in less than 30 seconds. Another much appreciated benefit is the ease of installation. The hitch bolts directly to the frame under the bed using the existing holes. 30,000 lbs capacity.



BW1000

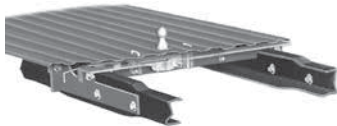

BW1000



BW1000



BW1000

## Turnover Ball (Bolt Together)

Rail Part #	Year	Description / Application
BW1000	1999-2000	Chevrolet & GMC ¾ & 1 Ton HD Long Bed (Full C-Channel Frame)
BW1050	1999-2000	Chevrolet & GMC ¾ & 1 Ton Short Bed (Full C-Channel Frame)
BW1059	1999-2007	Chevrolet & GMC ½ & ¾ Ton <b>Light Duty</b> Short & Long Beds (Tube Frame changing to C-Channel before axle)
BW1062	2001-2007	Chevrolet & GMC 1 Ton ( <b>With 2 bed cross members over the axle</b> )
BW1057	2007-2016	Chevrolet & GMC ½ Ton Short Bed New Boxed Frame
BW1007	2007-2016	Chevrolet & GMC ½ Ton Long Bed New Boxed Frame
BW1067	2001-2010	Chevrolet & GMC ¾ Ton <b>Heavy Duty</b> Short & Long Beds
BW1012	2007-2010	Chevrolet & GMC 1 Ton ( <b>New Body</b> ) (With 1 bed cross member over the axle)
BW1016	2011-2015	Chevrolet & GMC ¾ & 1 Ton <b>Heavy Duty</b> Long & Short Beds
BW1016	2016	Chevrolet & GMC ¾ & 1 Ton <b>Heavy Duty</b> Long & Short Beds
BW1197	1997-2003	Ford ½ Ton & ¾ <b>Light Duty</b> Ton
BW1104	2004 Ford	Ford Heritage Edition
BW1104	2004-2014	Ford ½ Ton (will fit Supercrew-must use <b>BW4085</b> extender)
BW1108	1999-2010	Ford ¾ & 1 Ton <b>Super Duty</b> Long and Short Beds
BW1108	2008-2010	Ford F450 with factory installed bed
BW1111	2011-2016	Ford ¾ & 1 Ton <b>Super Duty</b> Long and Short Beds
BW1111	2011-2016	Ford F450 with factory installed bed
BW1115	2015-2016	Ford F150 with aluminum bed
BW1316	2002-2008	Dodge ½ Ton Long and Short Beds (Except Mega-Cab)
BW1316	2003-2009	Dodge ¾ & 1 Ton Long and Short Beds - Gas or Diesel
BW1313	2010-2012	Dodge ¾ & 1 Ton Long and Short Beds - Except Mega Cab & Gas Engine
BW1313	2013	Dodge ¾ & 1 Ton Long and Short Beds - Diesel Engine
BW1308	2006-2012	Dodge ½, ¾ & 1 Ton Mega Cab
BW1308	2010-2012	Dodge ¾ & 1 Ton Long and Short Beds - Gas Engine
BW1308	2013	Dodge ¾ Ton Mega Cab
BW1308	2013	Dodge ¾ Ton Long and Short Beds - Gas Engine
BW1309	2009-2016	Dodge ½ Ton All Beds - Except trucks w/ four-corner air suspension system ( <b>BW4685</b> sole accessory that works with this hitch)
BW1314	2013-2016	Dodge 1 Ton
BW1384	2014-2016	Dodge ¾ Ton with coil springs
BW1208	2004-2015	Nissan Titan All Beds
BW1251	2000-2006	Toyota Tundra All Beds
BW1257	2007-2016	Toyota Tundra All Beds ( <b>BW4585</b> sole accessory that works with this hitch)
BW1257	2007-2016	This ball cannot be stored in the inverted position

## Turnover Ball (One-Piece)

Rail Part #	Year	Description / Application
BW1300	1973-1993	Dodge ½, ¾ & 1 Ton (Requires Drilling)
BW1400	1973-1987	Chevrolet & GMC ½, ¾ & 1 Ton (Requires Drilling)

## Turnover Ball Accessories

<b>BW3000</b>	<b>BW2025</b>	<b>BW2050</b>	<b>BW4000</b>	<b>BW4025</b>	<b>BW4075</b>	<b>BW4085</b>	<b>BW4200</b>

Part #	Description / Application	Part #	Description / Application
BW1500	Flatbed Kit 6"x 8"-½" Plate - 1/8" Socket Top Stick Out	BW3000	Companion 5th Wheel RV Hitch Kit - 18K
BW1600	Safety Chain U-bolt Replacement Kit	BW3050	Companion 5th Wheel RV Hitch Kit for Flatbeds
BW1700	Hitch Hole Plug (will not fit BW1257 or BW1309)	BW4000	Inverted King Pin
BW1705	Ball Hole Plug for Toyota #BW1257	BW4025	Inverted Ball (25/16" Coupler)
BW1900	Latch Pin Handle	BW4075	Eyelet
BW2000	Replacement 25/16" Ball	BW4085	4" Gooseneck Extender (25/16" Ball)
BW2025	Replacement 3" Ball	BW4200	10" Extend-A-Goose (25/16" Ball)
BW2050	Hi-Rise Ball (Rated at 20,000 lbs) - 25/16" Ball		



## Fifth Wheels & Rail Kits

Part #	Brand	Trailer GVW	Max Vertical	Adjustment Height	Description
6005DT	-	22,000 lbs	5,000 lbs	-	Universal Rail & Installation Kit for Hidden Hitch, Draw-Tite, Reese, Curt and other Fifth Wheels and accessories. Fits full size trucks.
30439	Mounting L-brackets and hardware ONLY for Universal Rail Kit				



**6005DT**

Part #	Brand	Trailer GVW	Max Vertical	Adjustment Height	Description
6032DT		15,000 lbs	-	-	Draw-Tite Fifth Wheel (Same as Reese #30032) Features side-to-side pivot for easier hookup on uneven ground. #6005DT Rail Kit NOT Included.



**6032DT**

Part #	Brand	Trailer GVW	Max Vertical	Adjustment Height	Description
6030		15,000 lbs	3,500 lbs	13" - 17"	Draw-Tite Fifth Wheel (Same as Reese #30031) #6005DT Rail Kit NOT Included.



**6030**

Part #	Brand	Trailer GVW	Max Vertical	Adjustment Height	Description
6021		20,000 lbs	5,000 lbs	14" - 18"	Draw-Tite Fifth Wheel (Same as Reese #30033) Features side-to-side pivot for easier hookup on uneven ground. #6005DT Rail Kit NOT Included.

**6021**

Part #	Brand	Trailer GVW	Max Vertical	Adjustment Height	Description
6022		22,000 lbs	5,500 lbs	13" - 17"	Draw-Tite Fifth Wheel (Same as Reese #30034) #6005DT Rail Kit NOT Included.

**6022**

Part #	Brand	Trailer GVW	Max Vertical	Adjustment Height	Description
30048		15,000 lbs	3,750 lbs	-	Slider Kit provides 9" additional turning clearance. For use with 14K, 15K and 16K Draw-Tite and Reese Fifth Wheel Hitches. #6005DT Rail Kit NOT Included.

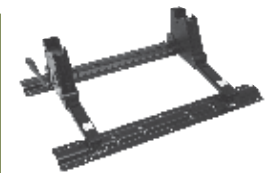

**30048**

### E5 Fifth Wheel

Part #	Brand	Description
16116		<ul style="list-style-type: none"> <li>• 16K towing capacity</li> <li>• Single handle operation</li> <li>• Auto lock mechanism</li> <li>• Dual pivot head</li> <li>• Gloss black finish</li> <li>• Includes mounting rails &amp; hardware</li> </ul>
16616	Mounting L-brackets and hardware ONLY for Universal Rail Kit	

**16116**

### Q5 Fifth Wheel

Part #	Brand	Description
6005DT		<ul style="list-style-type: none"> <li>• 20K towing capacity</li> <li>• Spherical axial bearing</li> <li>• Positive locking dual jaw system w/360° pin contact &amp; lock indicators</li> <li>• Self-aligning head</li> <li>• Lockable for trailer security</li> <li>• Carbide black finish</li> <li>• Includes mounting rails &amp; hardware</li> </ul>
30439	Mounting L-brackets and hardware ONLY for Universal Rail Kit	

**16616**

**16126**

Information

Hubs  
& Axles

Brake  
Assemblies

Suspensions  
& Fasteners

Tires &  
Wheels

Couplers  
Jacks &  
Winches

Hitches &  
Towing  
Accessories

Body  
Components

Trailer Parts

Lights &  
Electrical

Locks &  
Cargo Control

Brake  
Actuating  
Systems

Switches



TDB



BX7445



BX4325



BX4330



BX7302



Standard Tab Style



Removable Tab Style



BX881I



BX88196

## Tow Bars

Part #	Brand	Description
TDB		Arm adjust up to 42" wide. 5,000 lbs towing capacity. Fits 2" balls, rust-resistant black, powder-coated steel.

## Aventa LX™

Part #	Brand	Description
BX7445		<ul style="list-style-type: none"> <li>Ball-in-socket cutting edge design</li> <li>Self-aligning, with quick disconnect hookup pins</li> <li>Dependable steel construction</li> <li>10,000 lbs Class IV rating</li> </ul>

## Aladdin®

Part #	Brand	Description
BX4325		<ul style="list-style-type: none"> <li>Easy fold-away aluminum motorhome mount tow bar</li> <li>Self-aligning, with 3-axis swivel design</li> <li>The ultimate in quick disconnecting</li> <li>5,000 lbs Class III rating</li> </ul>

## Acclaim™

Part #	Brand	Description
BX4330		<ul style="list-style-type: none"> <li>Easy-folding, self-aligning, ball mount tow bar</li> <li>Automatically locks into towing position</li> <li>Detaches with two pins</li> <li>5,000 lbs Class III rating</li> </ul>

## Ambassador™

Part #	Brand	Description
BX7302		<ul style="list-style-type: none"> <li>A-frame tow bar</li> <li>Mounts to towed vehicle baseplate</li> <li>Quick mounting and dismounting</li> <li>5,000 lbs Class III rating</li> </ul>

### Base Plates

Removable tabs further enhance the aesthetics. When you aren't towing, just remove the tabs to make your base plate virtually invisible to the casual observer. When you're ready to tow, the tabs are easily locked into place.

NOTE: Base plates for specific vehicles are available by special order!



## Tail Light Wiring Kit

Part #	Brand	Description
BX881I		<ul style="list-style-type: none"> <li>Connects towed vehicle light system to the RV's brake light wiring</li> <li>Includes diode block to prevent electrical feedback</li> </ul>

## Safety Cable Kit

Part #	Class	Brand	Description
BX88196	Class III		<ul style="list-style-type: none"> <li>Plastic-coated, aircraft-grade cable</li> </ul>
BX88197	Class IV		<ul style="list-style-type: none"> <li>Heavy-gauge steel connectors</li> </ul>

## Balls

A "Ball" is the spherically shaped member with a neck and seat. The seat rests upon a hitch platform. A threaded portion of the ball shank extends through the hitch platform and is fastened to it with a lock washer and nut so that the ball will remain tight on the hitch.

### Classification:

Balls are classified by relating the diameter of the ball to a specific Trailer Classification.

Trailer Classification	Ball Diameter
Class 1	1 $\frac{1}{8}$ "
Class 2	2"
Class 3	2"
Class 4	2 $\frac{5}{16}$ "

### Types:

There are many types of balls on the market. Some are made in one piece, others are made in two or more pieces (a bolt extends down through the center of the ball portion). They are also made in various heights and shapes.

### Identification:

Most balls are identified on the top with the ball diameter such as 1 $\frac{1}{8}$ ", 2", etc. The ball should be used with the Trailer Classification as described above. It is recommended that a ball conforming to the strength and dimensional requirements of SAE J684 be use with a BULLDOG coupler.

## 1 $\frac{1}{8}$ " Ball Diameter (A)

Part # Zinc Finish	Part # Chrome Finish	Part # Stainless Steel	Shank Diameter (B)	Shank Length (C)	Capacity	Notes
5011	-	-	$\frac{3}{4}$ "	1 $\frac{1}{2}$ "	2,000 lbs	Bulk
-	5013	-	$\frac{3}{4}$ "	1 $\frac{1}{2}$ "	2,000 lbs	Retail Package
5021	5022	-	$\frac{3}{4}$ "	2 $\frac{3}{8}$ "	2,000 lbs	Bulk
-	4102	-	$\frac{3}{4}$ "	3 $\frac{3}{8}$ "	2,000 lbs	X-Long Shank
-	5033	-	1"	2 $\frac{3}{8}$ "	2,000 lbs	Retail Package
4121DT	-	-	1"	3 $\frac{3}{8}$ "	2,000 lbs	X-Long Shank
-	-	2291	1"	2 $\frac{1}{8}$ "	5,000 lbs	Retail Package



5033



## Pintle Hitch Replacement Ball

Part # Zinc Finish	Part # Chrome Finish	Part # Stainless Steel	Shank Diameter (B)	Shank Length (C)	Capacity	Notes
-	2301	-	1"	2 $\frac{1}{4}$ "	2,000 lbs	Pintle Hook Replacement
-	2307	-	1 $\frac{1}{8}$ "	2 $\frac{1}{4}$ "	2,000 lbs	Pintle Hook Replacement



2031

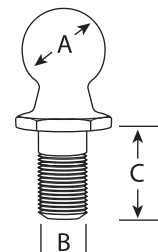

Information

Hubs  
& Axles

Brake  
Assemblies

Suspensions  
& Fasteners

Tires &  
Wheels

Couplers  
Jacks &  
Winches

Hitches &  
Towing  
Accessories

Body  
Components

Trailer Parts

Lights &  
Electrical

Locks &  
Cargo Control

Brake  
Actuating  
Systems

Switches

## 2" Ball Diameter (A)

Part # Zinc Finish	Part # Chrome Finish	Part # Stainless Steel	Shank Diameter (B)	Shank Length (C)	Capacity	Notes
-	2082	-	3/4" Internal	1 3/4"	3,500 lbs	Internal Thread

Part # Zinc Finish	Part # Chrome Finish	Part # Stainless Steel	Shank Diameter (B)	Shank Length (C)	Capacity	Notes
-	5063	-	3/4"	1 1/2"	3,500 lbs	Retail Package
-	-	2292	3/4"	2 1/4"	5,000 lbs	Retail Package
* 5071	5072	-	3/4"	2 3/8"	3,500 lbs	Retail Package
-	4112DT	-	3/4"	3 3/8"	3,500 lbs	X-Long Shank
-	5083	-	1"	2 1/8"	6,000 lbs	Retail Package
-	-	2293	1"	2 1/4"	7,000 lbs	Retail Package
-	2203	-	1"	2 1/8"	8,000 lbs	Heavy Duty
-	4132	-	1"	3 3/8"	6,000 lbs	X-Long Shank
-	2192	-	1 1/4"	2 1/8"	8,000 lbs	Bulk

NOTE: \* Bulk - Not packaged

Part # Zinc Finish	Part # Chrome Finish	Part # Stainless Steel	Shank Diameter (B)	Shank Length (C)	Capacity	Notes
-	80020	-	1"	2"	5,000 lbs	2" Rise Ball

Part # Zinc Finish	Part # Chrome Finish	Part # Painted Steel	Shank Diameter (B)	Shank Length (C)	Capacity	Notes
-	2302	-	1"	2 1/4"	10,000 lbs	Pintle Hook Replacement
-	2308	-	1 1/8"	2 1/4"	7,000 lbs	Pintle Hook Replacement
-	-	2312	1 1/4"	3"	7,500 lbs	Pintle Hook Replacement

## 2 5/16" Ball Diameter (A)

Part # Painted Finish	Part # Chrome Finish	Part # Stainless Steel	Shank Diameter (B)	Shank Length (C)	Capacity	Notes
-	-	2294	1"	2"	10,000 lbs	Retail Package
-	5044	-	1"	2 1/8"	8,000 lbs	Retail Package
-	5042	-	1"	2 1/8"	8,000 lbs	Bulk
-	5092	-	1 1/4"	2 1/4"	10,000 lbs	Retail Package
2195	-	-	1 1/4"	2 1/4"	25,000 lbs	Bulk

Part # Zinc Finish	Part # Chrome Finish	Part # Plain or Painted	Shank Diameter (B)	Shank Length (C)	Capacity	Notes
-	2303	-	1"	2 1/4"	10,000 lbs	Pintle Hook Replacement
-	2309	-	1 1/8"	2 1/8"	10,000 lbs	Pintle Hook Replacement
-	2310	-	1 1/4"	2 1/4"	12,000 lbs	Pintle Hook Replacement
-	-	2311	1 1/4"	3"	9,000 lbs	Pintle Hook Replacement

Part # Zinc Finish	Part # Chrome Finish	Part # Plain or Painted	Shank Diameter (B)	Shank Length (C)	Capacity	Notes
-	-	2190	1 1/4"	2 1/4"	30,000 lbs	1" Rise



2082



2082



80020

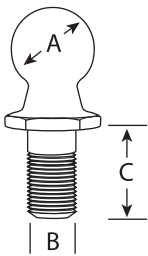

2312



2190



2311

### 2<sup>5</sup>/<sub>16</sub>" Ball Diameter (A) - (continued)

Part # Zinc Finish	Part # Chrome Finish	Part # Plain or Painted	Shank Diameter (B)	Shank Length (C)	Capacity	Notes
-	-	7047	1 <sup>1</sup> / <sub>4</sub> "	3 <sup>1</sup> / <sub>2</sub> "	30,000 lbs	1" Rise, Extra Long Shank
-	-	7048	1 <sup>3</sup> / <sub>8</sub> "	3 <sup>1</sup> / <sub>2</sub> "	30,000 lbs	1" Rise, Extra Long Shank

Part # Zinc Finish	Part # Chrome Finish	Part # Plain or Painted	Shank Diameter (B)	Shank Length (C)	Capacity	Notes
-	80025	-	1 <sup>1</sup> / <sub>4</sub> "	2"	7,500 lbs	2" Rise
-	-	2196	1 <sup>1</sup> / <sub>4</sub> "	2 <sup>1</sup> / <sub>8</sub> "	30,000 lbs	2" Rise
-	-	2198	1 <sup>1</sup> / <sub>2</sub> "	2 <sup>3</sup> / <sub>4</sub> "	30,000 lbs	2" Rise

Part # Zinc Finish	Part # Chrome Finish	Part # Plain or Painted	Shank Diameter (B)	Shank Length (C)	Capacity	Notes
-	-	2193	1 <sup>3</sup> / <sub>8</sub> "	2 <sup>1</sup> / <sub>4</sub> "	40,000 lbs	Bulk

Part # Zinc Finish	Part # Chrome Finish	Part # Plain or Painted	Shank Diameter (B)	Shank Length (C)	Capacity	Notes
-	-	5973	2 <sup>3</sup> / <sub>16</sub> "	2 <sup>3</sup> / <sub>4</sub> "	30,000 lbs	Smooth Shank
-	-	* 2184	2 <sup>3</sup> / <sub>16</sub> "	4"	30,000 lbs	Smooth Shank

**NOTE:** \* Uses #2185 collar (shown below)

### 3" Ball Diameter (A)

Part # Zinc Finish	Part # Plain or Painted	Shank Diameter (B)	Shank Length (C)	Capacity	Notes
-	2300	2"	3 <sup>1</sup> / <sub>4</sub> "	20,000 lbs	Bulk
6303	-	2 <sup>3</sup> / <sub>16</sub> "	2 <sup>3</sup> / <sub>4</sub> "	30,000 lbs	Smooth Shank

### Trailer Ball Cover

Part #	Description
2576	Fits 17/8" and 2" Trailer Balls
2577	Fits 25/16" Trailer Balls

### Reducer Bushings/Collar

Part #	Description
2561	Adapts 3/4" Shank Ball to fit 1" Hole
2562	Adapts 1" Shank Ball to fit 1 <sup>1</sup> / <sub>4</sub> " Hole
2185	Collar for #2184 Smooth Shank Ball, 3" long, 23/16" ID, 2 <sup>3</sup> / <sub>4</sub> " OD

### Trailer Hitch Grease

Part #	Description
211748	For use on trailer hitch ball and coupling. Contains rust and oxidation inhibitors and PTFE for added friction reduction. Water washout resistant. Tubes can stand alone or be pegged.



**80025**



**2184**



**6303**



**2576**

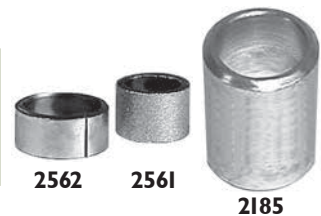

**2562**

**2561**

**2185**



**211748**

Information

Hubs  
& Axles

Brake  
Assemblies

Suspensions  
& Fasteners

Tires &  
Wheels

Couplers  
Jacks &  
Winches

Hitches &  
Towing  
Accessories

Body  
Components

Trailer Parts

Lights &  
Electrical

Locks &  
Cargo Control

Brake  
Actuating  
Systems

Switches



The Original  
**CONVERT-A-BALL®**  
Interchangeable Hitch System Products



700B

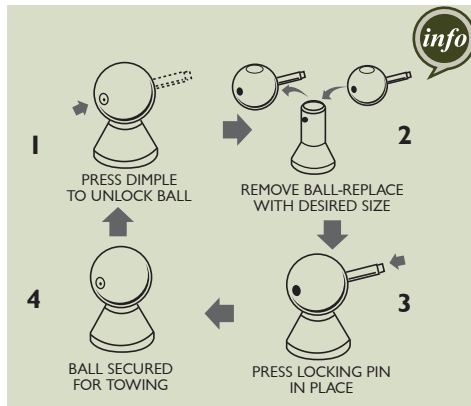

103B



003B

003B

11600

004B

## Chrome Ball and Shanks

\*

Part #	Description	Capacity
101B	¾" Shank	3,500 lbs
102B	1" Reg. Shank	10,000 lbs
105B	1" Extra Long Shank, ¾" Long Thread	10,000 lbs
300B	1⅞" Ball	-
400B	2" Ball	-
600B	2⅝" Ball	-
700B	Set: ¾" Reg. Shank, 1⅞" & 2" Balls	3,500 lbs
800B	Set: ¾" Long Shank, 1⅞" & 2" Balls	3,500 lbs
900B	Set: 1" Reg. Shank, 1⅞", 2" & 2⅝" Balls	10,000 lbs
901B	Set: 1" Reg. Shank, 1⅞" & 2⅝" Balls	10,000 lbs
904B	Set: 1" Reg. Shank, 2" & 2⅝" Balls	10,000 lbs
105LB	Set: 1" Super Long Shank, 1⅞" & 2" Balls	10,000 lbs
105TB	Set: 1" Super Long Shank, 1⅞", 2" & 2⅝" Balls	10,000 lbs
801B	Set: ¾" Forged Shank, 1⅞" & 2" Balls	5,000 lbs

**NOTE:** \* 2⅝" Ball will not fit on ¾" Shank

Rated Class 4. Rated V-5. Meets SAE Standard J-684.

## Stainless Steel Balls and Shanks

Part #	Description	Capacity
* 104B	¾" Long Forged	5,000 lbs
106B	1" Reg. Shank	10,000 lbs
301B	1⅞" Ball	-
401B	2" Ball	-
601B	2⅝" Ball	-
* 802B	Set: ¾" Long Shank, 1⅞" & 2" Balls	5,000 lbs
902B	Set: 1" Reg. Shank, 1⅞", 2" & 2⅝" Balls	10,000 lbs
903B	Set: 1" Reg. Shank, 1⅞" & 2⅝" Balls	10,000 lbs
906B	Set: 1" Reg. Shank, 2" & 2⅝" Balls	10,000 lbs
107TB	Set: 1" Super Long Shank, 1⅞", 2" & 2⅝" Balls	10,000 lbs
107LB	Set: 1" Super Long Shank, 1⅞" & 2" Balls	10,000 lbs

**NOTE:** \* 2⅝" Ball will not fit on ¾" Shank

Rated Class 4. Rated V-5. Meets SAE Standard J-684.

## Storage

Part #	Description
002B	2-ball rack used to store balls. Balls are not included.
003B	3-ball rack used to store balls. Balls are not included.
004B	3-ball plastic box used to store and protect balls with cover. Colors: Grey or Tan. Balls are not included
005B-R	Shank cover in red
005B-B	Shank cover in black
005B-G	Shank cover in gray

## Ball Mounts w/ 2 and 3 Welded Trailer Balls

Part #	Ball Size	Capacity (Ball Size)	Finish
2480	1 $\frac{7}{8}$ " & 2"	2,000 lbs (1 $\frac{7}{8}$ ") & 3,000 lbs (2")	Black Painted
2481	1 $\frac{7}{8}$ " & 2 $\frac{5}{16}$ "	2,000 lbs (1 $\frac{7}{8}$ ") & 6,000 lbs (2 $\frac{5}{16}$ ")	Black Painted
2482	2" & 2 $\frac{5}{16}$ "	3,500 lbs. (2") & 6,000 lbs (2 $\frac{5}{16}$ ")	Black Painted



Part #	Ball Size	Capacity (Ball Size)	Finish
2483	1 $\frac{7}{8}$ ", 2" & 2 $\frac{5}{16}$ "	6,000 lbs (1 $\frac{7}{8}$ ") & 10,000 lbs (2" & 2 $\frac{5}{16}$ ")	Black Painted



Part #	Ball Size	Capacity (Ball Size)	Finish
2485	1 $\frac{7}{8}$ ", 2" & 2 $\frac{5}{16}$ "	6,000 lbs (1 $\frac{7}{8}$ ") & 10,000 lbs (2" & 2 $\frac{5}{16}$ ")	Chrome Balls

Part #	Ball Size	Capacity (Ball Size)	Finish
2484	1 $\frac{7}{8}$ ", 2" & 2 $\frac{5}{16}$ "	6,000 lbs (1 $\frac{7}{8}$ ") & 10,000 lbs (2" & 2 $\frac{5}{16}$ ") Adjusts up to 6" Rise or 6" Drop	Black Painted Chrome Balls
2484-1	1 $\frac{7}{8}$ ", 2" & 2 $\frac{5}{16}$ "	Replacement Tri-ball Insert Only	



Part #	Description
2486	Tri-Ball mount with Pintle Hook; Pintle rating 7,500 lbs; 2 $\frac{5}{16}$ " rating 10,000 lbs; 2" rating 7,500 lbs; 1 $\frac{7}{8}$ " rating 6,000 lbs; 2" Solid Shank.

Part #	Description
2472	Tri-Ball mount with Tow Hook; Hook rating 7,500 lbs; 25/16" rating 10,000 lbs; 2" rating 7,500 lbs; 17/8" rating 6,000 lbs; 2" Shank.

## Tow Hooks

Part #	Finish	Capacity	Size	Opening	Bolt Centers	Hole Size
6012	Black	10,000 lbs	LH	LH	LH	LH
6013	Black	10,000 lbs	RH	RH	RH	RH
6014	Black	15,000 lbs	LH	LH	LH	LH
6015	Black	15,000 lbs	RH	RH	RH	RH
80010	Chrome	10,000 lbs	-	-	-	-

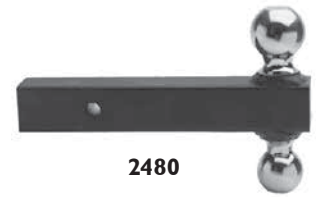

2480



2483



2485



2484



2486



2472



6012

80010

Information

Hubs  
& Axles

Brake  
Assemblies

Suspensions  
& Fasteners

Tires &  
Wheels

Couplers  
Jacks &  
Winches

Hitches &  
Towing  
Accessories

Body  
Components

Trailer Parts

Lights &  
Electrical

Locks &  
Cargo Control

Brake  
Actuating  
Systems

Switches

## B & W Receiver Hitch

The B&W Tow & Stow™ Receiver Hitch is a revolutionary ballmount that is not only the most versatile on the market, but also the safest. The Tow & Stow™ allows you to keep it attached to your vehicle at all times, plus keep it out of the way with its patented stow-away design. Its innovated design allows the ballmount to stow underneath the vehicle to help prevent getting bruised shins and broken garage doors. The Tow & Stow™ has up to a Class IV rating so you can tow almost anything worry free.

- Eliminate the need for multiple ball mounts.
- Stow under the vehicle when not in use.
- Keeps the hitch out of the way of shins and garage doors.
- Manufactured from solid steel for a lifetime of reliable towing.
- Fits any standard 2 inch receiver hitch.
- Rotate the ball to the desired size.
- Raise or lower the hitch in one inch increments for a safe level tow.
- Available in 6, 8 and 10 inch models.
- Triball mount is available in 1 $\frac{1}{8}$ " x 2" x 2 $\frac{5}{16}$ ".
- Double ball mount is available in 2 $\frac{5}{16}$ " x 2" or 1 $\frac{1}{8}$ " x 2".
- Black powder coated for a durable and long lasting finish.



Pull the pins... Rotate the ball Adjust the height... Stow the hitch!



TS10047B



## Tow & Stow™ Receiver Hitches

Class IV - 10,000 lbs Capacity

Part #	Ball Size	Model	Drop	Rise
TS10033B	2 $\frac{5}{16}$ " x 2"	Model 6	3"	3 $\frac{1}{2}$ "
TS10037B	2 $\frac{5}{16}$ " x 2"	Model 8	5"	5 $\frac{1}{2}$ "
TS10040B	2 $\frac{5}{16}$ " x 2"	Model 10	7"	7 $\frac{1}{2}$ "
TS10047B	2 $\frac{5}{16}$ " x 2" x 1 $\frac{7}{8}$ "	Model 6	3"	3 $\frac{1}{2}$ "
TS10048B	2 $\frac{5}{16}$ " x 2" x 1 $\frac{7}{8}$ "	Model 8	5"	5 $\frac{1}{2}$ "
TS10049B	2 $\frac{5}{16}$ " x 2" x 1 $\frac{7}{8}$ "	Model 10	7"	7 $\frac{1}{2}$ "

## B & W Pintle Hitch

- The Pintle Hitch offers the same features as the Tow & Stow™
- 15" vertical height adjustment
- Use as a Pintle or standard 2" or 2-5/16" ball mount
- Easily hook up to any trailer
- 16,000 lbs Trailer Weight as Pintle
- 10,000 lbs Trailer Weight as Ball Mount



## Tow & Stow™ Pintle Hitches

Part #	Description
TS10055	Pintle Hitch 2" Ball
TS10056	Pintle Hitch 2 $\frac{5}{16}$ " Ball

## Tow & Stow™ Accessories

Part #	Description
TS35010	Stainless Steel Pins (Long) with Clip
1128	$\frac{5}{32}$ " x 3" Hairpin Clip (Zinc)
TS35020	Silencer Pad (Black)
TS35012	6" Stainless Cover Plate
TS35013	8" Stainless Cover Plate
TS35014	10" Stainless Cover Plate



TS10055



TS35010



TS35020



TS35012



## Aluminum Rapid Hitches

Part #	Ball Size	Drop	Capacity	Mfg #	Weight
3460	2" and 2 $\frac{5}{16}$ "	3 $\frac{3}{4}$ "	8K/10K	3460	17 lbs
2497	1 $\frac{7}{8}$ " and 2"	5 $\frac{1}{2}$ "	7.5K/8K	3411	18 lbs
2487	2" and 2 $\frac{5}{16}$ "	5 $\frac{1}{2}$ "	8K/10K	3410	18 lbs
2467	1 $\frac{7}{8}$ " and 2"	10"	7.5K/8K	3414	20 lbs
2478	2" and 2 $\frac{5}{16}$ "	10"	8K/10K	3413	21 lbs
3473	2" and 2 $\frac{5}{16}$ "	10"	8K/10K	3473	25 lbs



3460



2478



2487

## Rapid Hitch Replacement Parts

Part #	Ball Size	Mfg #	Weight
2488	Rapid Hitch 1 $\frac{7}{8}$ " Ball only	3426	4.0 lbs
2477	Rapid Hitch 1 $\frac{7}{8}$ " and 2" Ball only	3425	5.22 lbs
2495	Rapid Hitch 2" and 2 $\frac{5}{16}$ " Ball only	3424	6.38 lbs
2494	Rapid Hitch Ball Pin 2 $\frac{3}{4}$ " x $\frac{5}{8}$ " (Old Style)	3430	0.33 lbs
2479	Rapid Hitch Platform Pin 4 $\frac{1}{4}$ " x $\frac{5}{8}$ "	3431	0.49 lbs
2471	Rapid Hitch Internal Pin for Ball Housing	3440	0.41 lbs
3441	3 $\frac{3}{4}$ " Drop/Rise Rack Only	3441	7.0 lbs
3422	5 $\frac{3}{4}$ " Drop/Rise Rack Only	3422	7.0 lbs
3442	10" Drop/Rise Rack Only	3442	8.8 lbs
2469	Ball Housing/Platform Only	3423	4.0 lbs



3426

3424

## Locks For Rapid Hitch

Part #	Ball Size	Mfg #	Weight
2490	Rapid Hitch Height Adjustment Platform Lock	3428	8.64 lbs
2492	Rapid Hitch Receiver Hitch Lock for Standard 2 & 2 $\frac{1}{2}$ " Hitch	3432	2.86 lbs
3429	Rapid Hitch Receiver Hitch Lock for 2 $\frac{1}{2}$ " Hitch	3429	1.80 lbs
2491	Rapid Hitch Lock Set Keyed Alike for Standard 2" Hitch	3434	2.37 lbs
3492	Rapid Hitch Lock Set Keyed Alike for 2 $\frac{1}{2}$ " Hitch	3492	2.86 lbs



3492

## 8K Aluminum Ball Mounts

Can be used in Drop or Rise position

Part #	Ball Size	Capacity	Mfg #	Weight
2541	2" Drop Aluminum Ball Mount 1" Hole	8,000 lbs	3503	3.4 lbs
2543	4" Drop Aluminum Ball Mount 1" Hole	8,000 lbs	3505	4.5 lbs
2545	6" Drop Aluminum Ball Mount 1" Hole	8,000 lbs	3507	5.5 lbs



2545

2543

2541

Information

Hubs  
& Axles

Brake  
Assemblies

Suspensions  
& Fasteners

Tires &  
Wheels

Couplers  
Jacks &  
Winches

Hitches &  
Towing  
Accessories

Body  
Components

Trailer Parts

Lights &  
Electrical

Locks &  
Cargo Control

Brake  
Actuating  
Systems

Switches

Information

Hubs  
& Axles

Brake  
Assemblies

Suspensions  
& Fasteners

Tires &  
Wheels

Couplers  
Jacks &  
Winches

Hitches &  
Towing  
Accessories

Body  
Components

Trailer Parts

Lights &  
Electrical

Locks &  
Cargo Control

Brake  
Actuating  
Systems

Switches



3590



36054



36061

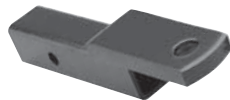

80212



2526



2540



2546

## 1 1/4" Square (1/2" Pin Hole) - Black Finish

Part #	Class Rating	Capacity GTW	Capacity TW	Hole Size	Length	Rise	Drop
3590	I	2,000 lbs	200 lbs	3/4"	6 5/8"	5/8"	-
3591	I	2,000 lbs	200 lbs	3/4"	9 3/4"	5/8"	-
36051	II	3,500 lbs	300 lbs	3/4"	7"	5/8"	1 1/4"
36052	II	3,500 lbs	300 lbs	3/4"	7"	1 3/4"	2 1/2"
36053	II	3,500 lbs	300 lbs	3/4"	9 3/4"	5/8"	1 1/4"
69250	II	3,500 lbs	300 lbs	3/4"	7 3/16"	2 1/4"	2 7/8"
36052	II	3,500 lbs	300 lbs	3/4"	7"	1 3/4"	2 1/2"
36071	II	3,500 lbs	300 lbs	3/4"	7 3/16"	2 5/8"	3 1/4"
3592	I	2,000 lbs	200 lbs	3/4"	9 3/4"	2 1/8"	2 3/4"
3593	I	2,000 lbs	200 lbs	3/4"	6 5/8"	2 1/8"	2 3/4"
36054	II	3,500 lbs	300 lbs	3/4"	7"	3 1/4"	4"
3594	I	2,000 lbs	200 lbs	3/4"	10"	4"	-
36061	II	3,500 lbs	300 lbs	3/4"	9 3/4"	3 1/8"	-
36063	II	3,500 lbs	300 lbs	3/4"	11 3/4"	3 1/8"	-
36065	II	3,500 lbs	300 lbs	3/4"	10"	5"	-

## 2" Square (5/8" Pin Hole) - Black Finish

Part #	Class Rating	Capacity GTW	Capacity TW	Hole Size	Length	Rise	Drop
2551	III	6,000 lbs	600 lbs	1"	8"	3/4"	2"
80212	III	6,000 lbs	600 lbs	1"	8"	3/4"	2"
2553	III	5,000 lbs	600 lbs	1"	12"	3/4"	2"
2552	III	6,000 lbs	600 lbs	1"	8"	3"	4"
2554	III	5,000 lbs	500 lbs	1"	12"	2"	3 1/4"
2555	III	5,000 lbs	500 lbs	1"	10 1/2"	3 3/4"	5"
2524	III	6,000 lbs	600 lbs	1"	9 1/2"	4 3/4"	6"
2526	III	6,000 lbs	600 lbs	1"	10"	6 3/4"	8"
2527	III	5,000 lbs	500 lbs	1"	10"	8 3/4"	10"
2540	IV	20,000 lbs	2,000 lbs	1 1/4"	8 1/2"	1"	2"
2542	IV	20,000 lbs	2,000 lbs	1 1/4"	8"	3"	4"
76990	IV	10,000 lbs	1,000 lbs	1 1/4"	7 1/4"	5"	6"
2544	IV	17,000 lbs	1,700 lbs	1 1/4"	9 1/2"	5"	6"
2546	IV	12,000 lbs	1,200 lbs	1 1/4"	9 1/2"	7"	8"



### 2" Square ( $\frac{5}{8}$ " Pin Hole) - Stainless Steel

Part #	Class Rating	Capacity GTW	Capacity TW	Hole Size	Length	Rise	Drop
76440	III	6,000 lbs	600 lbs	1"	8 $\frac{1}{4}$ "	2"	3 $\frac{1}{4}$ "



76440

### 2" Square ( $\frac{5}{8}$ " Pin Hole) - Zinc Finish

Part #	Class Rating	Capacity GTW	Capacity TW	Hole Size	Length	Rise	Drop
4284	IV	10,000 lbs	1,000 lbs	1 $\frac{1}{4}$ "	12"	1"	2"



4284

### 2 $\frac{1}{2}$ " Square ( $\frac{5}{8}$ " Pin Hole)

Part #	Class Rating	Capacity GTW	Capacity TW	Hole Size	Length	Rise	Drop
445122	V	13,000 lbs	1,200 lbs	1 $\frac{1}{4}$ "	10"	1 $\frac{1}{2}$ "	3"
445123	V	13,000 lbs	1,200 lbs	1 $\frac{1}{4}$ "	10"	3 $\frac{1}{2}$ "	5"
445124	V	13,000 lbs	1,200 lbs	1 $\frac{1}{4}$ "	10 $\frac{1}{2}$ "	-	7 $\frac{3}{4}$ "



445122



### Dual Receiver Adapter

### 2" Square ( $\frac{5}{8}$ " Pin Hole) - Black Powder Coat

Part #	Class Rating	Capacity GTW	Capacity TW	Hole Size	Length	Rise	Drop
1804010	I & II	4,000 lbs	3 $\frac{5}{8}$ "	6 $\frac{3}{16}$ "	7 $\frac{1}{2}$ "	8 $\frac{13}{16}$ "	17 $\frac{1}{4}$ "



1804010

Information

Hubs & Axles

Brake Assemblies

Suspensions & Fasteners

Tires & Wheels

Couplers, Jacks & Winches

Hitches & Towing Accessories

Body Components

Trailer Parts

Lights & Electrical

Locks & Cargo Control

Brake Actuating Systems

Switches



2528



1802310



80420



80421



80422



2535



2539



2505

## 2" Square Adjustable Ball Mounts ( $\frac{5}{8}$ " Pin Hole)

Part #	Class Rating	Capacity GTW	Capacity TW	Hole Size	Length	Rise	Drop
2528	III	6,000 lbs	600 lbs	1"	12 $\frac{3}{4}$ "	9 $\frac{5}{8}$ "	11"
2529	III	10,000 lbs	1,200 lbs	1 $\frac{1}{4}$ "	13 $\frac{1}{4}$ "	9 $\frac{1}{2}$ "	12 $\frac{7}{8}$ "
1802310	IV	12,000 lbs	1,200 lbs	3 @ 1" 1 @ 1 $\frac{1}{4}$ "	12 $\frac{1}{8}$ "	6"	6"
2528-1	III	6,000 lbs	600 lbs	Replacement Ball Platform for #2528			



## Cushion Ball Mounts

(Fits 2" Receiver Hitch Tube)

Part #	Receiver Opening	Hole Size	Length	Rise	Drop	Mfg #	Note
80420	2" x 2"	1"	7 $\frac{3}{4}$ "	1"	2"	BCP102101	Black Powder Coated
80421	2" x 2"	1"	7 $\frac{3}{4}$ "	3"	4"	BCP104101	Black Powder Coated
80422	2" x 2"	1"	7 $\frac{3}{4}$ "	5"	6"	BCP106101	Black Powder Coated

## Pintle Mounts

( $\frac{5}{8}$ " pin hole. For pintles with (4)  $\frac{1}{2}$ " bolt mounting)

Part #	Shank	Description	Capacity
2534	2" Solid	8 Holes, 6 $\frac{5}{8}$ " Face to Center of Pin	10,000 GVWR
2535	2" Solid	8 Holes, 9 $\frac{1}{2}$ " Face to Center of Pin	10,000 GVWR
2539	2" Solid	14 Holes, 10 $\frac{1}{8}$ " Face to Center of Pin	10,000 GVWR
45156	2 $\frac{1}{2}$ " Tube	6 Holes, 7 $\frac{3}{4}$ " Face to Center of Pin	12,000 GVWR
45294	2 $\frac{1}{2}$ " Forged	8 Holes, 8 $\frac{1}{2}$ " Face to Center of Pin	18,000 GVWR

## Solid Shanks

Part #	Length	Description
2505	12"	2" square with $\frac{5}{8}$ " pin hole. Pin hole center is drilled 2 $\frac{5}{8}$ " from one end of shank.
2519	24"	

## Step Bumper Hitches

(Includes Mounting Hardware)

Part #	Capacity GTW	Capacity TW	Description
2507	3,500 lbs	350 lbs	2" square. 5/8" pin hole. Fits most full size trucks with step bumpers
2521	3,500 lbs	350 lbs	4" drop. 1" ball size. Do not accept ball mounts.
2523	3,500 lbs	350 lbs	6" drop. 1" ball size. Do not accept ball mounts.



2507



2521



80300



80303



2517



2525



2515

## Receiver Tubes

Part #	Description	Part #	Description
2515	1 1/4" Square, 6" Long, 1/2" Pin Hole	2513	2" Square, 18" Long, 5/8" Pin Hole
2506	2" Square, 6" Long, 5/8" Pin Hole	2514	2" Square, 24" Long, 5/8" Pin Hole
2512	2" Square, 12" Long, 5/8" Pin Hole	2538	2" Square, 36" Long, 5/8" Pin Hole
2537	2 1/2" Square, 12" Long, 5/8" Pin Hole	2516	2" Square, 48" Long, 5/8" Pin Hole

## Tube Covers

Part #	Description	Part #	Description
2574	1 1/4" Square, Black Plastic, Press-In	2575	2" Square, Chrome Plastic, 5/8" Pin
5363	2" Square, Black Plastic, Press-In	5330	2" Square, Black Rubber, Flip-Up



2574



2575



5330

Information

Hubs & Axles

Brake Assemblies

Suspensions & Fasteners

Tires & Wheels

Couplers, Jacks & Winches

Hitches & Towing Accessories

Body Components

Trailer Parts

Lights & Electrical

Locks & Cargo Control

Brake Actuating Systems

Switches

# SECTION G

Information

Hubs  
& Axles

Brake  
Assemblies

Suspensions  
& Fasteners

Tires &  
Wheels

Couplers  
Jacks &  
Winches

Hitches &  
Towing  
Accessories

Body  
Components

Trailer Parts

Lights &  
Electrical

Locks &  
Cargo Control

Brake  
Actuating  
Systems

Switches



2560

## Bent Pins w/Hairpin Clip

Part #	Description	Description
2558	1/2"	2"
2560	5/8"	3"
1128	Replacement hairpin for #2558 and 2560 - 5/32" x 3" (Zinc)	

Part #	Pin Diameter	Usable Length	Note
74149	5/8"	3"	Fits 2 1/2" Hitches



25014

## Cargo Carriers

(See our Draw-Tite catalog for additional cargo carriers and accessories)

Part #	Class Rating	Capacity GTW	Capacity TW	Hole Size	Length	Rise
52014	2"	20" x 60"	500 lbs	Expanded Metal	Painted Steel	Folds in half for compact storage



52012

Part #	Class Rating	Capacity GTW	Capacity TW	Hole Size	Length	Rise
52012	2"	24" x 60"	500 lbs	Expanded Metal	Painted Steel	Raised welded rails Fixed shank



86112

Part #	Class Rating	Capacity GTW	Capacity TW	Hole Size	Length	Rise
86112	2"	20" x 60"	500 lbs	Solid	Galvanized Steel	Order adapter #86115 for 1 1/4" receivers

## Weight Distribution & Sway Control

Weight distribution kits are recommended for vehicles towing weights in excess of 5,000 lbs. Weight Distribution removes excess weight from rear axle of the tow vehicle (fig. 1) and distributes it over all axles of the vehicle and trailer (fig. 2). Weight Distribution provides level load, better braking and handling, less strain on vehicle and greater towing capacity.

info

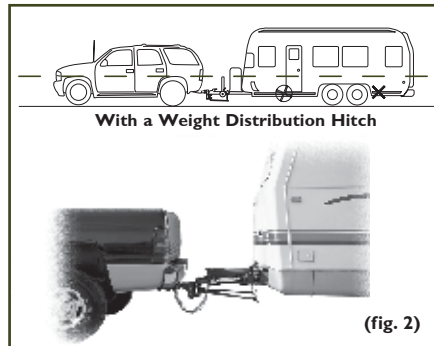
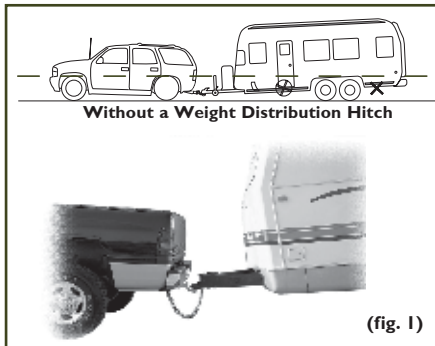

## Weight Distribution Kits

(More weight distribution kits and replacement parts available by request)

Part #	Rated Capacity Tongue Weight Gross Trailer Weight	Drop
51090	1,200 lbs 12,000 lbs	Round bar style with built in sway control ball platform. Includes brackets, handle, bars, chain, hitch head, 10" shank and hardware. Allows up to 5¾" rise and 2¼" drop.
51091	1,000 lbs 10,000 lbs	Trunnion (square) bar style with built in sway control ball platform. Includes brackets, handle, bars, chain, hitch head, 10" shank and hardware. Allows up to 6¾" rise and 1¼" drop.
6637	-	Hook-up brackets (1-pair) with handle.
3210	-	Shank only
3216	-	Chain kit. Contains 2 chains, u-bolts, nuts and lock washers.
3311	-	Round bar retainer spring clips. Includes 2 spring clips and screws.
62115	1,000 lbs	Round spring bar kit. Contains 2 spring bars and chain kit.
3279	-	Round bar hitch head. Includes attachment hardware, pin and clip.
6666	1,000 lbs	Trunnion spring bar kit. Contains 2 spring bars and chain kit.
7979	-	Trunnion bar hitch head. Includes attachment hardware, pin and clip.

## Sway Control

(More sway control kits and replacement parts available by request)

Part #	Drop
51092	Friction Sway Control Assembly. Used to reduce trailer sway and improve handling in adverse conditions. Easy hook-up and removal. Adjustable friction for multiple towing situations.
3401	Sway Control Fastener Kit. Includes mounting hardware (self-tapping screws) and clips.
3422DT	Inner slide bar with vehicle end socket.
3442DT	Weld-on ball mounting bar
3443	1¼" ball with ⅝" shank. Includes nut and lock washer.
3458	Main body assembly. Does not include inner slide bar.
3473-DT	Ball and plate assembly. Trailer side. Does not include mounting hardware or clip.
40660	Standard friction sway control and adapter, screw-on sway control assembly w/hardware. Black powder coat finish.



**DRAW-TITE**

Information

Hubs  
& Axles

Brake  
Assemblies

Suspensions  
& Fasteners

Tires &  
Wheels

Couplers  
Jacks &  
Winches

Hitches &  
Towing  
Accessories

Body  
Components

Trailer Parts

Lights &  
Electrical

Locks &  
Cargo Control

Brake  
Actuating  
Systems

Switches





## 1,000 to 18,000 lb Hitches and Receivers

Complete information and application charts for Draw-Tite products are available on request. We stock a large assortment of hitches. If you need a hitch or part, and do not have our hitch literature, **just tell us the Make, Model and Year of Vehicle, Capacity required, Ball Size (if needed) and any other Pertinent Facts.** You will get the best hitch we have available for the vehicle and load.

### Note:

GTW = Gross Trailer Weight (pounds)

TW = Tongue Weight (pounds) provides level load, better braking and handling, less strain on vehicle and greater towing capacity.

### Class I Sportframe Hitches Part No. Series 24XXX

Economical Class I receiver style hitch includes removable drawbar, pin & clip. 1 1/4" square receiver tube opening. Attaches to frame and bumper.



### Class II Frame Hitches Part No. Series 35XXX

Receiver style hitch includes removable drawbar, pin & clip. 1-1/4" square receiver tube opening. Attaches to frame.

### Square & Round Tube Max-Frame Receivers Part No. Series 75XXX

Designed for vehicles rated 8,000 lb or less. 2" square receiver tube opening. Attaches to frame.

### Max-E-Loader Receivers Part No. Series 41XXX

Long side bracket design distributes the towing load over a greater portion of the tow vehicle frame, making it the ideal receiver for maximum duty. 2" square receiver tube opening. Attaches to frame.



### Ultra Frame Receivers Part No. Series 419XX

Strong and secure heavy duty side bracket design. 2" square receiver tube opening. Attaches to frame.

### Titan™ Receivers Part No. Series 45XXX

Strong and secure heavy duty side bracket design. 2-1/2" square receiver tube opening. Pin, clip, receiver tube cover, and welded electrical bracket included. Attaches to frame.

### Front Mounted Receivers Part No. Series 650XX

For winches, accessories, or spotting. 2" square receiver opening. Attaches to frame.



## Pro Series™ Class III/IV Square & Round Tube Receiver Hitches



- Solid all-welded construction for maximum strength and safety
- Custom built according to manufacturer & model year to ensure perfect fit and top towing performance
- Computer-aided design and fatigue stress testing ensure a strong design that will withstand road abuse within specified capacities
- All hitches meet or exceed V-5 and SAE J684 standards and are inspected for quality and workmanship
- Backed by a nationwide 3-year limited warranty
- 2" square receiver tube opening
- Pro Series™ receivers are designed for customers with trucks, vans and sport utility vehicles
- Designed for today's stylish sport utility vehicles, round tube receivers complement vehicle appearance
- All frame attachments
- J-Pin ready



### Maximum Rated Capacity

Description	Gross Trailer Wt.	Tongue Wt.
Weight Carrying	Up to 6,000 lbs	Up to 600 lbs
Weight Distributing	Up to 10,500 lbs	Up to 1,050 lbs

Make	Model	Style	From Year	To Year	WC	WD	No Drill	Hitch FN	Part #
Acura	MDX	Except w/Full Size Spare Tire	2001	2006	3K	5K	yes	GP,JR	451159
BMW	X5		2000	2006	6K	6K		AA,EP	451093
Buick	Enclave		2008	2016	5K	5K	yes	GP,JR	451083
Buick	Rendezvous		2002	2007	3.5K			HM	451151
Buick	Terraza		2005	2007	3.5K	5K		AL,GP,JR	451079
Chevrolet	Avalanche 1500, 2500		2002	2006	6K	8K	yes	CN,HM	451201
Chevrolet	Colorado		2004	2012	6K	7.5K	yes	CP,GP	451074
Chevrolet	Colorado		2015	2016	5K	6K	yes	HM,V,SO	451239
Chevrolet	Equinox		2005	2015	3.5K	4K	yes	HM	451193
Chevrolet	Express 1500		2004	2014	5K	10K	yes	HM	451023
Chevrolet	Express 2500, 3500		2004	2016	5K	10K	yes	HM	451023
Chevrolet	Silverado 1500, 1500 HD	Including Classic	2003	2013	5K	7.5K	yes	JL	451072
Chevrolet	Silverado 1500, 1500 HD	Including Classic	2003	2013	6K	10.5K	yes	JL	451081
Chevrolet	Silverado 1500		2014	2016	5K	8K	yes	HM,JL	451235
Chevrolet	Silverado 2500 HD, 3500, 3500 HD	Including Classic	2003	2010	5K	7.5K	yes	CS,FS,JL,LT	451073
Chevrolet	Suburban 1500, 2500	w/Amber Turn Signals	2003	2006	6K	8K	yes	CN,HM	451201
Chevrolet	Tahoe	w/Amber Turn Signals	2003	2006	6K	8K	yes	CN,HM	451201
Chevrolet	Traverse		2009	2016	5K	5K	yes	GP,JR	451083
Chevrolet	Uplander		2005	2008	3.5K	5K		AL,GP,JR	451079
Chevrolet	Uplander	(Canada Only)	2009	2009	3.5K	5K		AL,GP,JR	451079
Chrysler	Aspen		2007	2009	5K	7.5K			451067
Chrysler	Pacifica		2004	2008	3.5K	5K	yes	JR	451084
Chrysler	Town & Country	Except w/Stow & Go Seats	2004	2007	3.5K	3.5K		HM	451062
Chrysler	Town & Country		2008	2016	4K	4K	yes	GP,JR	451203
Dodge	Caravan, Grand Caravan	Except w/Stow & Go Seats	2004	2007	3.5K	3.5K		HM	451062
Dodge	Dakota		2005	2010	5K	8K	yes	HM	451138
Dodge	Durango		2004	2009	5K	7.5K			451067
Dodge	Grand Caravan		2008	2016	4K	4K	yes	GP,JR	451203
Dodge	Journey		2009	2016	4K	4K	yes	HM,JR	451208
Dodge	Nitro		2007	2011	5K	6K	yes	GP	451089
Dodge	Ram 1500, 2500, 3500		2006	2008	5K	8K	yes	CP,GU	451143
Ford	Crown Victoria		1998	2009	3.5K	6K		CA,GP	451103
Ford	E-150, E-250 Econoline	Except E-250 Super Wagon Cargo Van	2003	2014	6K	8K	yes		451094
Ford	E-350 Econoline Super Duty		2003	2014	6K	8K	yes		451094
Ford	Edge	Except Sport	2007	2014	4K			CP,GP,JR,KH	451200
Ford	Escape		2005	2012	3.5K	5K	yes	HM	451232
Ford	Escape		2013	2016	3.5K	4K	yes	HM,TP	451233
Ford	Explorer		2011	2016	4K	5K	yes	HM,JR,L	451202
Ford	F-150		2006	2008	6K	10K	yes	CP,HM	451075
Ford	F-150		2009	2014	5K	10K	yes	CP,HM	451097
Ford	F-150		2015	2016	5K	8K	yes	HM,JL	451238
Ford	F-250 Super Duty, F-350 Super Duty	Except Cab & Chassis	2005	2007	6K	10K	yes	EB,HM	451068
Ford	F-250 Super Duty, F-350 Super Duty	Except Cab & Chassis	2005	2007	6K	10K	yes	FP,GP	451095
Ford	Ranger		2004	2011	3.5K	5K		V	451032

Information  
Hubs & Axles  
Brake Assemblies  
Suspensions & Fasteners  
Tires & Wheels  
Couplers, Jacks & Winches  
Hitches & Towing Accessories  
Body Components  
Trailer Parts  
Lights & Electrical  
Cargo Control  
Locks & Cargo Control  
Brake Actuating Systems  
Switches

**Pro Series™ Class III/IV Square & Round Tube Receiver Hitches (continued)**

Make	Model	Style	From Year	To Year	WC	WD	No Drill	Hitch FN	Part #
GMC	Acadia		2007	2015	5K	5K	yes	GP,JR	451083
GMC	Canyon		2004	2012	6K	7.5K	yes	CP,GP	451074
GMC	Canyon		2015	2016	5K	6K	yes	HM,V,SO	451239
GMC	Savana 1500		2004	2014	5K	10K	yes	HM	451023
GMC	Savana 2500, 3500		2004	2016	5K	10K	yes	HM	451023
GMC	Sierra 1500, 1500 HD	Including Classic	2003	2013	5K	7.5K	yes	JL	451072
GMC	Sierra 1500, 1500 HD	Including Classic	2003	2013	6K	10.5K	yes	JL	451081
GMC	Sierra 1500		2014	2016	5K	8K	yes	HM,JL	451235
GMC	Sierra 2500 HD, 3500, 3500 HD	Including Classic	2003	2010	5K	7.5K	yes	CS,FS,JL,LT	451073
GMC	Terrain		2010	2016	3.5K	4K	yes	HM	451193
GMC	Yukon	w/Amber Turn Signals	2003	2006	6K	8K	yes	CN,HM	451201
GMC	Yukon XL 1500, XL 2500		2003	2006	6K	8K	yes	CN,HM	451201
Honda	CR-V		2007	2011	3.5K		yes	HM,JR	451205
Honda	CR-V		2012	2016	3.5K		yes	HM,JR,SV	451209
Honda	Odyssey		2005	2016	3.5K	5K	yes	HM,JR	451156
Honda	Pilot		2003	2008	3.5K	5K	yes	CS,GP,JR	451159
Honda	Ridgeline		2006	2014	5K	6K	yes	HM,JR	451139
Hyundai	Santa Fe		2001	2006	3.5K		yes	GP,JR	451088
Hyundai	Santa Fe		2007	2009	3.5K		yes		451076
Hyundai	Santa Fe		2010	2012	3.5K	5K	yes	HM	451206
Isuzu	I-280, I-350		2006	2006	6K	7.5K	yes	GP	451074
Isuzu	I-290, I-370		2007	2008	6K	7.5K	yes	GP	451074
Jeep	Cherokee	Except Trailhawk	2014	2014	5K	5K	yes	HM	451237
Jeep	Cherokee	Except Trailhawk & V6 Models	2015	2016	5K	5K	yes	HM	451237
Jeep	Commander		2006	2010	5K	7.5K	yes		451149
Jeep	Compass	Fascia trimming required on Rallye Edition	2007	2015	3.5K		yes	EP,GP	451085
Jeep	Grand Cherokee	Except SRT-8	2005	2010	5K	7.5K	yes	AI	451149
Jeep	Grand Cherokee	Except w/ECO Diesel Engine	2011	2015	5K	7.5K	yes	AI,GP	451195
Jeep	Liberty		2005	2007	5K	7.5K	yes	GP	451054
Jeep	Patriot		2007	2016	3.5K		yes	EP,GP	451085
Jeep	TJ	(Canada Only)	1998	2006	4K		yes	HM	451145
Jeep	Wrangler		1998	2006	4K		yes	HM	451145
Jeep	Wrangler	Except Hard Rock Edition, 75th Anniversary Edition & vehicles with Mopar Off Road Bumper #82213654.	2007	2016	3.5K	4K	yes		451077
KIA	Sorento		2003	2009	5K	5K	yes	HM	451082
KIA	Sorento	Base I4, EX I4, EX V6, LX I4, LX V6, SX V6	2011	2013	3.5K	5K	yes	HM	451206
Lexus	RX330		2004	2006	3.5K		yes	HM	451155
Lexus	RX350		2007	2009	3.5K		yes	HM	451155
Lexus	RX400h	Hybrid	2006	2008	3.5K		yes	HM	451155
Lincoln	Mark LT	(Built After 8/2005)	2006	2008	6K	10K	yes	CP,HM	451075
Lincoln	Mark LT	(Built Before 8/2005)	2006	2006	5K	10K	yes	KM	451064
Lincoln	MKX		2007	2015	4K			CP,GP,JR,KH	451200
Lincoln	Town Car		1990	2011	3.5K	6K		AB,CA,EO,GP,HA	451103
Mazda	B2300, B4000		2002	2009	3.5K	5K		V	451032
Mazda	B3000		2002	2008	3.5K	5K		V	451032
Mazda	Tribute		2005	2011	3.5K	5K	yes	HM	451232
Mercury	Grand Marquis		1998	2011	3.5K	6K		CA,GP	451103
Mercury	Mariner		2005	2011	3.5K	5K	yes	HM	451232
Mitsubishi	Raider		2006	2009	5K	8K	yes	HM	451138
Nissan	Frontier		2005	2016	5K	8K	yes	GP	451147
Nissan	Titan		2004	2015	6K	10K	yes		451106
Pontiac	Montana SV6		2005	2006	3.5K	5K		AL,GP,JR	451079
Pontiac	Montana SV6	(Canada Only)	2007	2009	3.5K	5K		AL,GP,JR	451079
Pontiac	Torrent		2006	2009	3.5K	4K	yes	HM	451193
RAM	C/V	Tradesman	2012	2015	4K	4K	yes	GP,JR	451203
RAM	Dakota		2011	2011	5K	8K		HM	451138
RAM	ProMaster 1500, 2500, 3500	All Models	2014	2016	5K		yes	AA,DU,GP	451236

**Pro Series™ Class III/IV Square & Round Tube Receiver Hitches** (continued)

Make	Model	Style	From Year	To Year	WC	WD	No Drill	Hitch FN	Part #
Saturn	Outlook		2007	2009	5K	5K	yes	GP,JR	451083
Saturn	Relay		2005	2007	3.5K	5K		AL,GP,JR	451079
Saturn	Vue		2002	2007	3.5K	4K	yes	HM	451193
Subaru	Legacy	Except Redline	2010	2016	4K			HM,JR,KH	451204
Subaru	Outback	Sedan	2010	2016	4K			HM,JR,KH	451204
Suzuki	Equator	Wagon, Except Sport	2009	2012	5K	8K	yes	GP	451147
Suzuki	XL-7		2002	2006	3.5K		yes	HM	451152
Toyota	FJ Cruiser		2007	2014	5K	6K	yes	GP	451087
Toyota	Highlander		2004	2007	3.5K		yes	HM	451155
Toyota	Highlander	Except w/Full Size 19" Spare Tire	2008	2013	5K	5K	yes	HM	451158
Toyota	RAV4		2006	2015	3.5K	4K	yes	HM,HX,JR	451234
Toyota	Sienna		2004	2010	3.5K	5K	yes	HM,JR	451080
Toyota	Sienna		2011	2016	3.5K	5K	yes	HM,JR,SV,SY	451080
Toyota	Sienna		2011	2016	3.5K	5K	yes	HM,SV	451196
Toyota	Tacoma	Except X-Runner	2005	2015	5K	5.5K	yes	GP	451146
Toyota	Tundra		2003	2006	5K	7.5K	yes	GP	451047
Toyota	Tundra	(See Footnote CP)	2007	2016	6K	8K	yes	CP,HM	451091
Volkswagen	Routan		2009	2012	4K	4K	yes	GP,JR	451203
Volkswagen	Routan	(Canada Only)	2013	2014	4K	4K	yes	GP,JR	451203

**FOOTNOTE:**

AA	Requires temporary removal of bumper during installation.
AB	Requires four (4) 3/8" spacer blocks (#01077011) for installation. (Sold separately)
AI	Additional installation time may be required.
AL	Additional installation time required for vehicles equipped with load leveling compressor.
CA	Models with dual exhaust require exhaust modification.
CN	Requires OEM factory bumper for hitch installation.
CP	Fits all models without factory installed receiver.
CS	Will fit with full-size spare tire stowed under vehicle.
DU	Fascia removal required.
EB	Factory electrical bracket will NOT fit with this hitch. Must use aftermarket electrical box or bracket.
EO	Requires longer ball mount.
EP	Fascia trimming may be required.
FP	Spare tire repositioning and/or modification of spare tire carrier may be required.
FS	Includes 2 & 4 WD models with heavy duty suspension.
GP	Hitch crosstube concealed behind bumper.
GU	Will not fit vehicles with factory or aftermarket lower Fascia/Rollpan or Tube Bumper.
HA	External dress panel beneath 95-97 and 03-05 vehicles must be removed for hitch installation.
HM	Hitch crosstube is visible beneath bumper.
HX	Minor exhaust modification may be required.
JL	Installation requires OEM bumper and brackets.
JR	Exhaust must be temporarily lowered for installation.
KH	Minor heat shield modification may be required.
KM	Does not work with models originally equipped with OEM hitch.
L	Exhaust repositioning required.
LT	Requires removal of factory hitch if equipped.
SO	With this hitch installed the step bumper is no longer able to be used as a towing point.
SV	Trimming or removal of under body appearance panel may be required.
SY	Hitch crosstube is visible beneath bumper with a more than normal gap between fascia and crosstube.
TP	Works with hands-free liftgate option.
V	For vehicles with factory installed step bumpers only.

Information

Hubs  
& Axles

Brake  
Assemblies

Suspensions  
& Fasteners

Tires &  
Wheels

Couplers  
Jacks &  
Winches

Hitches &  
Towing  
Accessories

Body  
Components

Trailer Parts

Lights &  
Electrical

Locks &  
Cargo Control

Brake  
Actuating  
Systems

Switches